

# Operator's Manual SUPPLEMENT

Model No.

285B-0

286B-0, 286U-0

*285B*  
*285B-1*

## ⚠ WARNING:

Read Engine Owner's Manual, Vehicle Operator's Manual, and Supplement Carefully Before Operating Vehicle.

Parts List



## ORDERING PARTS

- FAST & EASY!**
- 1) Seek Part(s) from your models illustrated diagram, cross over REF# to PART#
  - 2) Type PART# into sites [Search Box] at [GoKartsRus.com](http://GoKartsRus.com) TIP! - RIGHT CLICK LINK, SELECT OPEN IN NEW TAB
  - 3) Add all needed parts to Shopping Cart | Complete "Checkout" | ✓ Done!
- LOWEST PRICES!**

If a part does not come up in a Site Search, please [Contact Us](#) (include part# in email)

# THIS VEHICLE IS FOR OFF-ROAD USE ONLY

BEFORE OPERATING THIS VEHICLE, THE OWNER AND/OR OPERATOR MUST UNDERSTAND THE VEHICLE WAS NOT DESIGNED OR MANUFACTURED TO MEET SPECIFICATIONS FOR USE ON STREETS, HIGHWAYS, OR THOROUGHFARES AND HAVE READ AND HAVE AN UNDERSTANDING OF ALL THE INSTRUCTIONS FOR SAFE ASSEMBLY AND OPERATION AS WELL AS THE INSTRUCTIONS GOVERNING THE ENGINE AND OTHER PORTIONS OF THE VEHICLE.

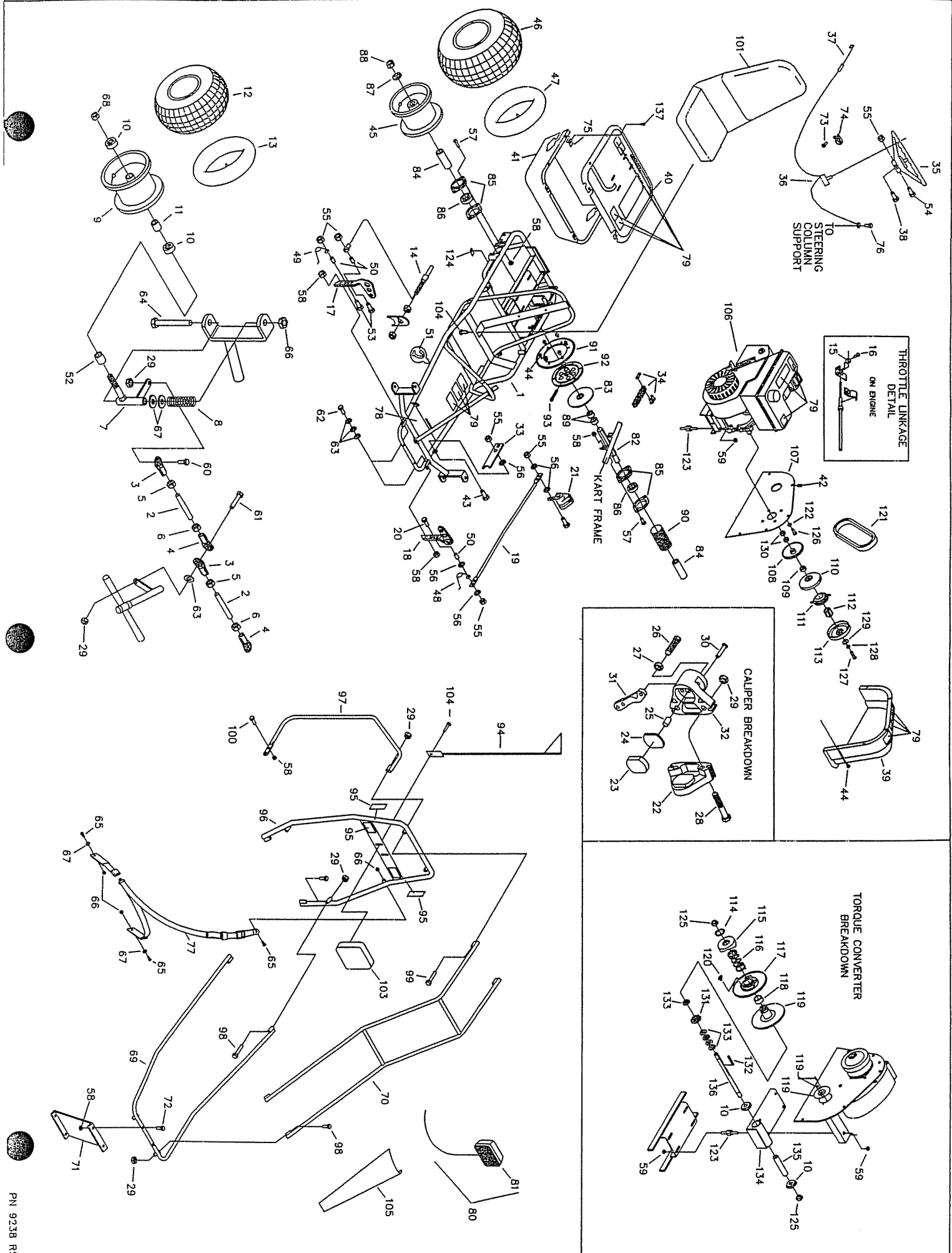

Ref	Part	Description	Ref	Part	Description	Ref	Part	Description
1	12112-2	FRAME WDMT GBLK 285	48	9502	SPRING PEDAL LEFT WOUND	101	11695D	SEAT - BACK/BOTTOM SGL P
ASM	1464	TIE ROD ASM (INCL 2-6)	49	9503	SPRING PEDAL RIGHT WOUND	103	6320	HEADREST SGL PLAIN
2	1465	TIE ROD 10.625	50	1389	BUSHING .25ID X .031G X .313	104	5839	BOLT 1/4-20 X .750 HH WF Z
3	1414	TIE ROD END RH	51	1019	CABLE TIE - BIG BLACK T40ROW	105	2257	CUSTOM COVER (286U-0, 286B-0 ONLY)
4	1415	TIE ROD END LH	52	5157-16	SPACER SPLIT .8120D .625ID 750L Z	106	11769	ENGINE 6.0HP OHV TEC (286B-0)
5	9092	NUT 3/8-24 HEX JAM Z	53	1847	BOLT 1/4-20 X 1.000 HHCS G5 Z	107	11768	ENGINE 5HP OHV TEC (285B-0)
6	9024	NUT 3/8-24 LH JAM	54	9080	BOLT 1/4-20 X 2.750 HHCS G2 Z	108	11775-2	PLATE COVER 2XX 4XX GBLK
7	2457-2Z	SPINDLE RH WDMT - GBLK W/ZERK	55	9057	NUT 1/4-20 TL Z	ASM	5957	DRIVER PULLEY 30S (INCL 108-113)
NI	2458-2Z	SPINDLE LH WDMT - GBLK W/ZERK	56	1854	WASHER #14 FLAT MS Z	109	200349	BUSHING
8	5681	SPRING COMPRESSION	57	2264	BOLT 5/16-18 X .750 HHCS G5 Z	110	*	MOVEABLE SHEAVE
9	9309FP	WH ASM 145/70 X 6" KN (INCL 10-12)	58	1189	NUT 5/16-18 HEX TL Z	111	*	SHOE ASSEMBLY
10	5090	BEARING 5/8 ID 1-3/8 OD SNAP RING	59	1263	NUT 5/16-18 HEX WF Z	112	*	HUB
11	5950	SPANNER 5/8 ID X 2-1/8 SSSZ	60	9146	BOLT 3/8-16 X 1.500 HHCS G5 Z	113	5958	DRUM
12	4915	TIRE 145/70 X 6 KN (REPAIR PART ONLY)	61	9145	BOLT 3/8-16 X 1.750 HHCS G5 Z	ASM	2477	DRIVEN PULLEY 30S (INCL 114-120)
13	3802	INNER TUBE 6"	62	1447	BOLT 5/16-18X11/16THD 3/8X1-1/8SHLD	114	6805	RETAINING RING
14	8252	THROTTLE CABLE 61 IN	63	9091	WASHER FLAT 3/8 SAE N	115	6805	CAM
15	2748	CABLE STOP NUT	64	5682	BOLT 1/2-13 X 5.500 HHCS G5 Z	116	6805	SPRING
16	2666	SWIVEL SCREW	65	9188	BOLT 1/2-13 X 1.50 HHCS G5 Z	117	6805	MOVEABLE SHEAVE
17	1437-16	PEDAL THROTTLE - ZINC PLTD	66	1012	NUT 1/2-13 TL HEX Z	118	6805	BUSHING
18	1436-16	PEDAL BRAKE - ZINC PLTD	67	9022	WASHER 1/2 STD FLAT Z	119	6804	STATIONARY SHEAVE
19	9744-2	BRAKE ROD - 225,285 GBLK	68	1046	NUT 5/8-11 TL HEX Z	120	5959	BUITON, NYLON
20	1848	BOLT 1/4-20 X 1.250 HHCS G5 Z	69	10475-2	FRONT BAR WDMT 2XX - GBLK	121	9060	BELT 30S
21	9597	BRAKE CALIPER MB1 (INCL 22-32)	70	10476-2	OVERHEAD BAR WDMT 2XX - GBLK	122	1356	WASHER 5/16 TYPE A PLAIN SAE N Z
ASM	9810	BRAKE PAD SERVICE KIT (INCL 22-29)	71	10488-2	FRONT PLATE 2XX - GBLK	123	2449	STUD ASM
22	*	ANVIL W/LINING	72	6573	BOLT 5/16-18 X 1.750 HHCS G5	124	1136	NUT TINNERMAN
23	*	BRAKE LINING	73	5287	BOLT #10-16X.375 SELF TAP BF, BG,	125	9101	BOLT 5/16-24 X .500 HHCS G5 NL
24	3928	BACKING PLATE	74	5288	WIRE CLAMP *	126	8204	BOLT 5/16-24 X 2.250 HHCS G5 YZ
25	3930	ACTUATOR PIN	75	11824	NUT TINNERMAN	127	1124	WASHER 5/16 SL Z
26	3931	ADJUSTER PIN	76	9796	BOLT #12-24 X .500 SELF TAPPING (285B-0 & 286B-0 ONLY)	128	1398	WASHER 21/64 ID X 1 1/4 X 1/8
27	3932	NUT, JAM	77	8373	SEAT BELT SHOULDER LAP COMPLETE	129	1938	SPACER .75ID 11GA .375 ZI
28	9158	BOLT 3/8-16 X 2-1/4"	78	1441	DECAL - FLOOR PAN SCUFF	130	8720	SPROCKET 420P 9T INTEGRAL KEY
29	9085	NUT, 3/8-16 TOPLOCK	79	11330	DECAL SHEET, ENGINE & MAIN FRAME WARNINGS	131	3403	KEY 3/16SQ X 2.000
ASM	6531	MB-1 SERVICE KIT (INCL 30-32)	82	9740H-16	AXLE HEX WDMT - ZINC PLTD	132	1119	SPACER .625ID 1.0620D .125THK Z
30	*	GROOVE PIN	83	9511H	BRAKE DISC 6 HEX	133	1110-2	CHASSIS WDMT-GBLK
31	*	LEVER	84	1448-16	SPACER 1.000ID 12G 3.563L ZINC PLTD	134	1116	SPANNER .625 X 11G X 4.188
32	*	BRAKE HOUSING	85	1760	BEARING FLANGE	135	1118	JACKSHAFT 5/8 X 10.000
33	1982-2	PEDAL LATCH-GBLK	86	3941H	BEARING PRECISION SEAL .875HEX	136	1876	BOLT 1/4-20 X .625 HH WF Z
34	9514	CHAIN 420 X 62P INC ML	87	1194	WASHER 3/4 SAE FLAT	NI	6477	OPERATORS MANUAL DINGO
35	6038	STEERING WHEEL	88	9162	NUT 3/4-10 HEX TL Z	NI	2684E	ENGINE OM TEC OHH50 OHH55
36	9799	STOP SWITCH ASM (285B-0 & 286B-0 ONLY)	89	2265-16	SPACER 1.000ID 12G .750L ZINC PLTD	NI	9247R5	ASSEMBLY INSTRUCTIONS DINGO
37	1406	HARNESSE EXTENSION (286B-0 & 286B-0 ONLY)	90	G0475	LOOM 4.75 L 1.625 ID	NI	8746M	VIDEO SAFETY MANCO
38	9160	BOLT 1/4-20 X .875 HHCS NL G5 Z	91	6282	SPROCKET LA 420P 54T			
39	11776	TAV COVER 2XX 4XX	92	6280H	SPROCKET HUB HEX			
40	11777	COVER TOP 2XX	93	6701	BOLT 5/16-18 X 1.250 SHCS			
41	11778	COVER BOTTOM 2XX	94	8445	FLAG SAFETY W/BRTK 3FT			
42	8227	NUT 1/4-20 CLIP	95	11329	DECAL SHEET, CENTER BAR WARNINGS			
43	1846	BOLT 1/4-20 X .750 HHCS G5 Z	96	9746-2	CENTER BAR WDMT - GBLK			
44	9006	BOLT 1/4-20 X .500 HH WF	97	10477-2	REAR BAR WDMT 2XX - GBLK			
45	10381	WH ASM 8" 18X350 KN (INCL 46)	98	2386	BOLT 3/8-16 X 3.500 HHCS G5 Z			
46	3548	TIRE 18/9.50 X 8	99	6452	BOLT 3/8-16 X 5.000 HHCS G5 Z			
47	1430	TUBE 18/9.5 X 8 (REPAIR PART ONLY)	100	9176	BOLT 5/16-18 X 1.000 HHCS G5 Z			