

Operator's Manual
SUPPLEMENT
Model No. 285B-2
286C-2

⚠ WARNING:

Read Engine Owner's Manual, Vehicle Operator's Manual, and Supplement Carefully Before Operating Vehicle.

Parts List



ORDERING PARTS

- FAST & EASY!**
- 1) Seek Part(s) from your models illustrated diagram, cross over REF# to PART#
 - 2) Type PART# into sites [Search Box] at GoKartsRus.com TIP! - RIGHT CLICK LINK, SELECT OPEN IN NEW TAB
 - 3) Add all needed parts to Shopping Cart | Complete "Checkout" | ✓ Done!
- LOWEST PRICES!**

If a part does not come up in a Site Search, please [Contact Us](#) (include part# in email)

**THIS VEHICLE IS FOR
OFF-ROAD USE ONLY**

BEFORE OPERATING THIS VEHICLE, THE OWNER AND/OR OPERATOR MUST UNDERSTAND THE VEHICLE WAS NOT DESIGNED OR MANUFACTURED TO MEET SPECIFICATIONS FOR USE ON STREETS, HIGHWAYS, OR THOROUGHFARES AND HAVE READ AND HAVE AN UNDERSTANDING OF ALL THE INSTRUCTIONS FOR SAFE ASSEMBLY AND OPERATION AS WELL AS THE INSTRUCTIONS GOVERNING THE ENGINE AND OTHER PORTIONS OF THE VEHICLE.

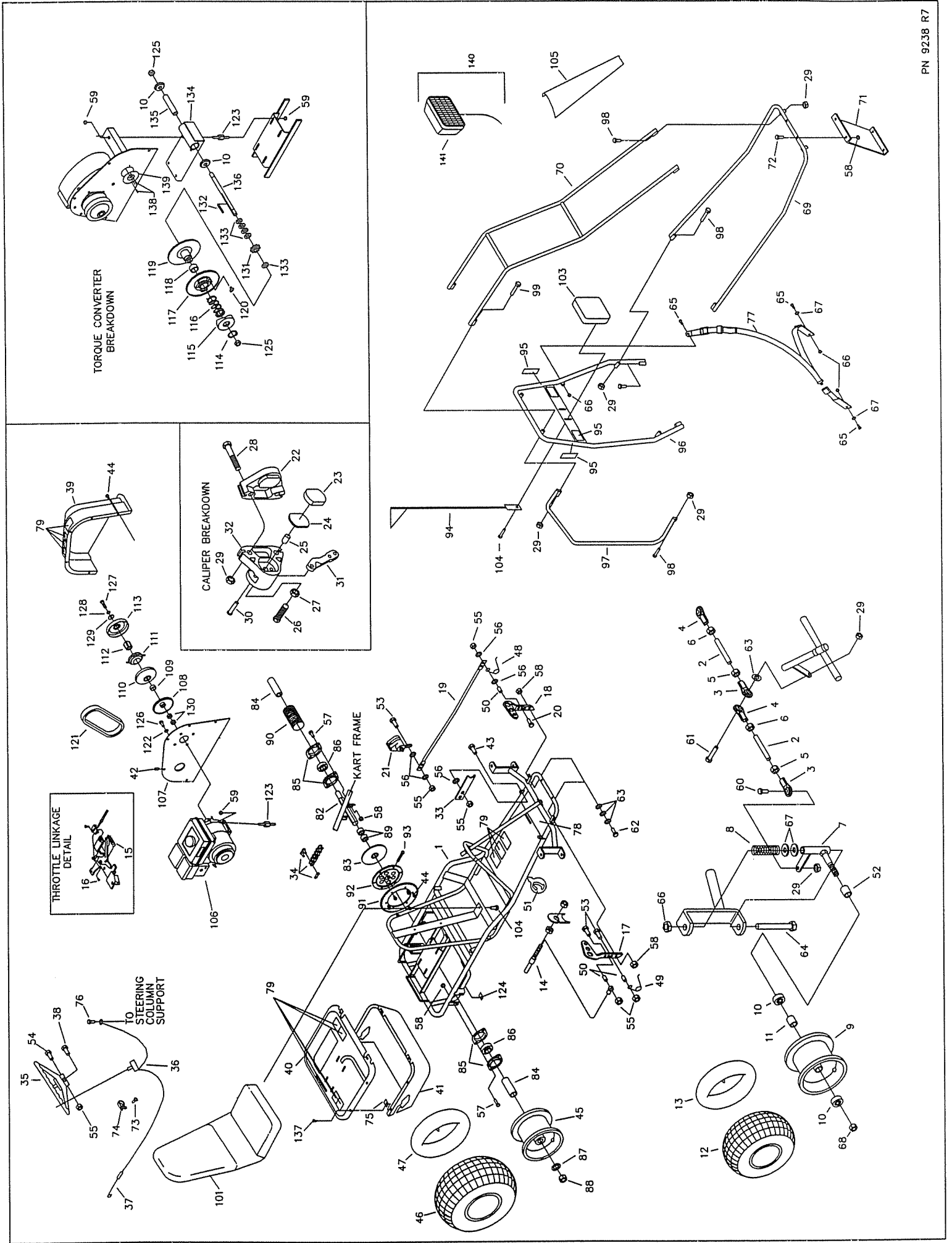

TORQUE CONVERTER
BREAKDOWN

CALIPER
BREAKDOWN

THROTTLE LINKAGE
DETAIL

KART
FRAME

TO
STEERING
COLUMN
SUPPORT

Ref	Part	Description	Ref	Part	Description	Ref	Part	Description
1	12211-2	FRAME WDMT GBLK 285, 286	48	9502	SPRING PEDAL LEFT WOUND	101	1636	SEAT - BACK/BOTTOM SGL P
ASM	1464	TIE ROD ASM (INCL 2-6)	50	9503	SPRING PEDAL RIGHT WOUND	103	6320	HEADREST SGL PLAIN
2	1465	TIE ROD 10.625	49	1389	BUSHING .25ID X .031G X .313	104	5839	BOLT 1/4-20 X .750 HH WF Z
3	1414	TIE ROD END RH	51	1019	CABLE TIE - BIG BLACK T40ROW	105	2257	CUSTOM COVER (286B-2X)
4	1415	TIE ROD END LH	52	5157-16	SPACER SPLIT .812OD .625ID 750L Z	106	12249	ENGINE 6.5HP OHC (286B-2X)
5	9092	NUT 3/8-24 HEX JAM Z	53	1847	BOLT 1/4-20 X 1.000 HHCS G5 Z	12250	12250	ENGINE 6.5HP OHC W/COIL (286C-2)
6	9024	NUT 3/8-24 LH JAM	54	9080	BOLT 1/4-20 X 2.750 HHCS G2 Z	12247	12247	ENGINE 5HP OHC (285B-2X)
7	2457-2Z	SPINDLE RH WDMT - GBLK W/ ZERK	55	9057	NUT 1/4-20 TL Z	107	11775-2	PLATE COVER 2XX 4XX GBLK
NI	2458-2Z	SPINDLE LH WDMT - GBLK W/ ZERK	56	1854	WASHER #14 FLAT MS Z	ASM	5957	DRIVER PULLEY 30S (INCL 108-113)
8	5681	SPRING COMPRESSION	57	2264	BOLT 5/16-18 X .750 HHCS G5 Z	108	*	STATIONARY SHEAVE
9	9309FP	WH ASM 145/70 X 6" KN (INCL 10-12)	58	1189	NUT 5/16-18 HEX TL Z	109	200349	BUSHING
10	5090	BEARING 5/8 ID 1-3/8 OD SNAP RING	59	1263	NUT 5/16-18 HEX WF Z	110	*	MOVEABLE SHEAVE
11	5950	SPANNER 5/8 ID X 2-1/8 SSZ	60	9146	BOLT 3/8-16 X 1.500 HHCS G5 Z	111	*	SHOE ASSEMBLY
12	4915	TIRE 145/70 x 6 KN (REPAIR PART ONLY)	61	9145	BOLT 3/8-16 X 1.750 HHCS G5 Z	112	*	HUB
13	3802	INNER TUBE 6"	62	1447	BOLT 5/16-18X11/16THD 3/8X1-1/8SHLD	113	*	DRUM
14	8251	THROTTLE CABLE 74.5 IN	63	9091	WASHER FLAT 3/8 SAE N	ASM	5958	DRIVEN PULLEY 30S (INCL 114-120)
15	12348	RETURN SPRING	64	5682	BOLT 1/2-13 X 5.500 HHCS G5 Z	114	2477	RETAINING RING
16	12347	SWIVEL SCREW	65	9188	BOLT 1/2-13 X 1.50 HHCS G5 Z	115	----	CAM
17	6309-16	PEDAL THROTTLE TRIMMD ZINC PLTD	66	1012	NUT 1/2-13 TL HEX Z	116	6805	SPRING
18	6293-16	PEDAL BRAKE TRIMMED ZINC PLTD	67	9022	WASHER 1/2 STD FLAT Z	117	----	MOVEABLE SHEAVE
19	12216-2	BRAKE ROD - 225,285 GBLK	68	1046	NUT 5/8-11 TL HEX Z	118	----	BUSHING
20	1848	BOLT 1/4-20 X 1.250 HHCS G5 Z	69	10475-2	FRONT BAR WDMT 2XX - GBLK	119	----	STATIONARY SHEAVE
21	9597	BRAKE CALIPER MB1 (INCL 22-32)	70	10476-2	OVERHEAD BAR WDMT 2XX - GBLK	120	6804	BUTTON, NYLON
ASM	9810	BRAKE PAD SERVICE KIT (INCL 22-29)	71	10488-2	FRONT PLATE 2XX - GBLK	121	5959	BELT 30S
22	*	ANVIL W/LINING	72	6573	BOLT 5/16-18 X 1.750 HHCS G5	122	9060	WASHER 5/16 TYPE A PLAIN SAE N Z
23	*	BRAKE LINING	73	5287	BOLT #10-16X.375 SELF TAP BF, BG,	123	1356	STUD ASM
24	3928	BACKING PLATE	74	5288	WIRE CLAMP	124	2449	NUT TINNERMAN
25	3930	ACTUATOR PIN	75	11824	NUT TINNERMAN	125	1136	NUT 5/8-18 CL HEX JAM Z
26	3931	ADJUSTER PIN	76	9796	BOLT #12-24 X .500 SELF TAPPING (285B-2X & 286B-2X ONLY)	126	9101	BOLT 5/16-24 X .500 HHCS G5 NL
27	3932	NUT, JAM	77	8373	SEAT BELT SHOULDER,LAP COMPLET	127	8204	BOLT 5/16-24 X 2.250 HHCS G5 YZ
28	9158	BOLT, 3/8-16 X 2-1/4"	78	1441	DECAL - FLOOR PAN SCUFF	128	1124	WASHER 5/16 SL Z
29	9085	NUT, 3/8-16 TOPLOCK	79	11330	DECAL - FLOOR PAN SCUFF	129	1398	WASHER 21/64 ID X 1 1/4 X 1/8
ASM	6531	MB-1 SERVICE KIT (INCL 30-32)	82	9740H-16	AXLE HEX WDMT - ZINC PLTD	130	1938	SPACER .75ID 11GA .375 ZI
30	*	GROOVE PIN	83	9511H	BRAKE DISC 6 HEX	131	8720	SPROCKET 420P 9T INTEGRAL KEY
31	*	LEVER	84	1448-16	SPACER 1.000ID 12G 3.563L ZINC PLTD	132	3403	KEY 3/16SQ X 2.000
32	*	BRAKE HOUSING	85	1760	BEARING FLANGE	133	1119	SPACER .625ID 1.062OD .125THK Z
33	1982-2	PEDAL LATCH-GBLK	86	3941H	BEARING PRECISION SEAL .875HEX	134	11806-2	CHASSIS WDMT-GBLK
34	9514	CHAIN 420 X 62P INC ML	87	1194	WASHER 3/4 SAE FLAT	135	10342	SPANNER .625 X 11G X 4.188
35	6038	STEERING WHEEL	88	9162	NUT 3/4-10 HEX TL Z	136	2777	JACKSHAFT 5/8 X 10.000
36	9799	STOP SWITCH ASM (285B-2X & 286B-2X ONLY)	89	2265-16	SPACER 1.000ID 12G .750L ZINC PLTD	137	1876	BOLT 1/4-20 X .625 HH WF Z
37	12273	WIRE HARNESS	90	G0475	LOOM 4.75 L 1.625 ID	138	8258	Rivet AL/AL .25GRIP .125DIA
38	9160	BOLT 1/4-20 X .875 HHCS NL G5 Z	91	6282	SPROCKET LA 420P 54T	139	8231	Cover Plate Extension
39	11776	TAV COVER 2XX 4XX	92	6280H	SPROCKET HUB HEX	140	12433	Running Light Assembly 286C
40	12258	COVER TOP 2XX	93	6701	BOLT 5/16-18 X 1.250 SHCS	141	5606	Running light 286C
41	12259	COVER BOTTOM 2XX	94	8445	FLAG SAFETY W/ BRKT 3FT	NI	11808	Cap Vinyl 1.5 ID 1.5LG .06 wall blk
42	8227	NUT 1/4-20 CLIP	95	11329	DECAL SHEET, CENTER BAR WARNINGS	NI	11863	Operators Manual - Fun Kart
43	1846	BOLT 1/4-20 X .750 HHCS G5 Z	96	9746-2	CENTER BAR WDMT - GBLK	NI	12268	Engine OM Robin - All
44	9006	BOLT 1/4-20 X .500 HH WF	97	12214-2	REAR BAR WDMT 2XX - GBLK	NI	11695R2	Instructions 285/286 ASM
45	10381	WH ASM 8" 18X950 KN (INCL 46)	98	2386	BOLT 3/8-16 X 3.500 HHCS G5 Z	NI	8746M	VIDEO SAFETY MANCO
46	3548	TIRE 18/9.50 X 8	99	6452	BOLT 3/8-16 X 5.000 HHCS G5 Z			
47	1430	TUBE 18/9.5 X 8 (REPAIR PART ONLY)						