

# Operator's Manual

## SUPPLEMENT

Model No. 415

### ⚠ WARNING:

Read Engine Owner's Manual, Vehicle Operator's Manual, and Supplement Carefully Before Operating Vehicle.

Parts List



### ORDERING PARTS

FAST & EASY!

- 1) Seek Part(s) from your models illustrated diagram, cross over REF# to PART#
- 2) Type PART# into sites [Search Box] at [GoKartsRus.com](http://GoKartsRus.com) TIP! - RIGHT CLICK LINK, SELECT OPEN IN NEW TAB
- 3) Add all needed parts to Shopping Cart | Complete "Checkout" | ✓ Done!

If a part does not come up in a Site Search, please [Contact Us](#) (include part# in email)

LOWEST PRICES!

# THIS VEHICLE IS FOR OFF-ROAD USE ONLY

BEFORE OPERATING THIS VEHICLE, THE OWNER AND/OR OPERATOR MUST UNDERSTAND THE VEHICLE WAS NOT DESIGNED OR MANUFACTURED TO MEET SPECIFICATIONS FOR USE ON STREETS, HIGHWAYS, OR THOROUGHFARES AND HAVE READ AND HAVE AN UNDERSTANDING OF ALL THE INSTRUCTIONS FOR SAFE ASSEMBLY AND OPERATION AS WELL AS THE INSTRUCTIONS GOVERNING THE ENGINE AND OTHER PORTIONS OF THE VEHICLE.

THROTTLE LINKAGE  
DETAIL

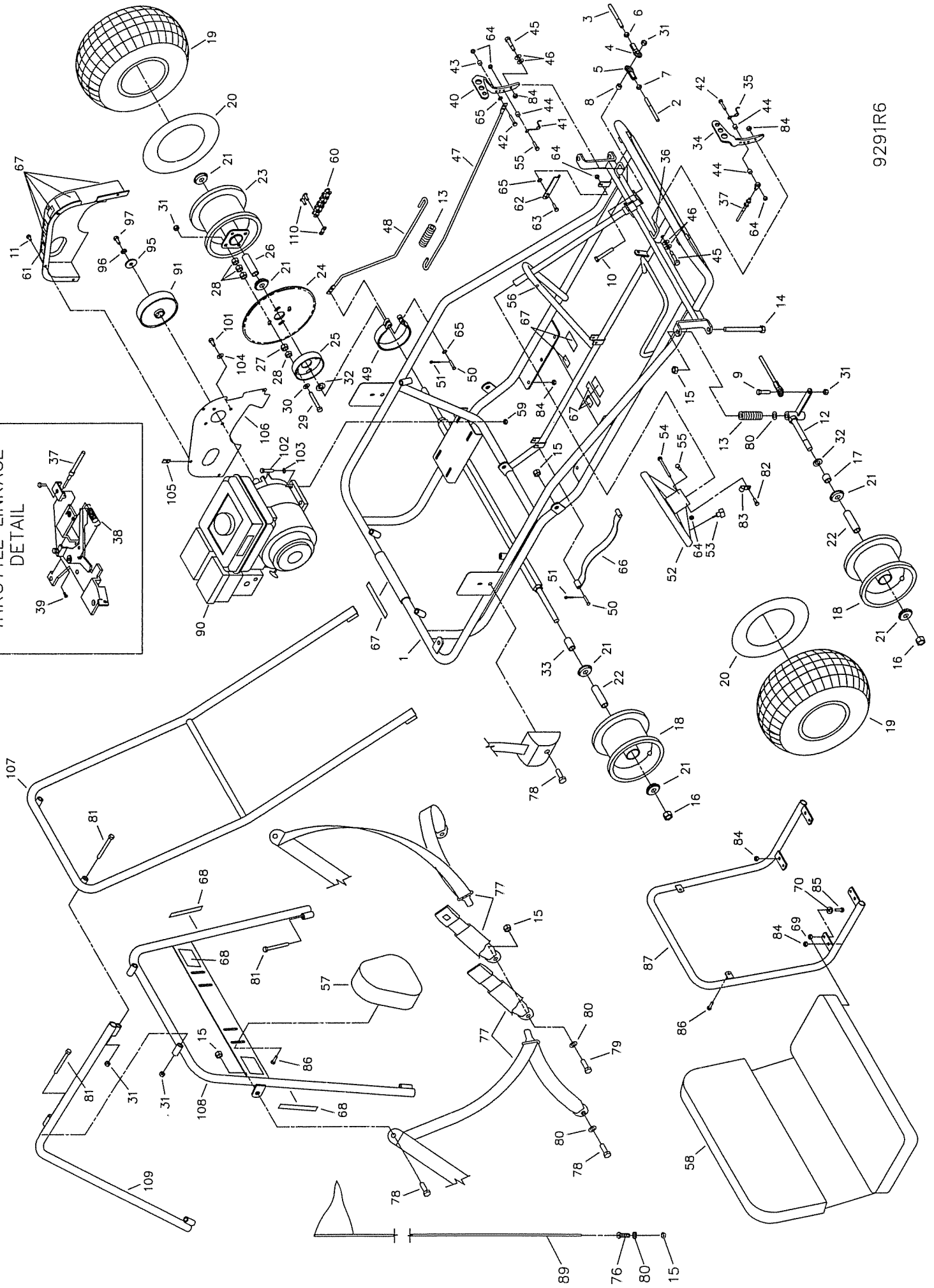

**PARTS LIST MODEL 415B/415D**

REF	PN	DESCRIPTION
1	12277-37	FRAME - RED WAGON
<b>ASM</b>	10869	TIE ROD ASM LONG (INCL. 2, 4-7)
<b>ASM</b>	5020	TIE ROD ASM SHORT (INCL. 3-7)
2	10868	TIE ROD 19.0
3	5004	TIE ROD 7.25
4	1415	TIE ROD END LH THREAD
5	1414	TIE ROD END RH THREAD
6	9024	NUT 3/8-24 JAM LH THREAD
7	9092	NUT 3/8-24 JAM RH THREAD
8	9674-16	SPACER 3/8 ID X 3/8 LONG
9	9146	BOLT 3/8-16 X 1.50
10	9158	BOLT 3/8-16 X 2.25
11	9006	BOLT 1/2-20 X .50 HEX FLANGED WHIZ
<b>NI</b>	10548-2Z	LEFT SPINDLE WITH ZERK - BLACK
12	10549-2Z	RIGHT SPINDLE WITH ZERK - BLACK
13	9709	COMPRESSION SPRING
14	5682	BOLT 1/2-13 X 5.500
15	13503	NUT 1/2-13 CENTERLOCK
16	13354	NUT 5/8-11 CENTERLOCK
17	1104	SPACER SPLIT .812OD .625ID 1.000L
18	12490	WHEEL ASSEMBLY 6 INCH (INCL. 19 - 22)
<b>ASM</b>	12492	WHEEL ASSEMBLY 6IN DRIVE (INCLS 19-21,23-31)
19	4915C	REPLACEMENT TIRE FOR 12490 & 12491
20	3802	REPLACEMENT TUBE FOR 12490 & 12491
21	5090	BEARING 5/8 I.D. X 1-3/8 OD SNAP RING
22	5950	SPANNER 5/8 I.D. X 2-1/8
23	12491	WHEEL ASSY 6 INCH DRIVE (INCL. 19 - 21 & 26)
24	9986	SPROCKET 35P 80T
25	1246-16	BRAKE DRUM - 4 INCH
26	8598	SPANNER 5/8ID X 14G X 3.641
27	9169	NUT 1/2-20 HEX JAM
28	8409	NUT 1/2-20 HEX
29	9190	BOLT 3/8-16 X 3.25 HHCS
30	9091	WASHER FLAT 3/8 SAE
31	9085	NUT 3/8-16 TOPLOCK HEX ZINC
32	1119	SPACER .625ID 1.062OD .125THK Z
33	2024-16	SPACER .875OD .625ID 1.500L ZINC
34	6309-16	THROTTLE PEDAL
35	9503	PEDAL SPRING - RIGHT WOUND

REF	PN	DESCRIPTION
36	9929	RUBBER CAP .25ID X .25 BLACK
37	8251	THROTTLE CABLE 74.50 INCH
38	12348	RETURN SPRING
39	12347	SWIVEL SCREW
40	6293-16	BRAKE PEDAL
41	9502	PEDAL SPRING - LEFT WOUND
42	1848	BOLT 1/2-20 X 1.25
43	6349	BUSHING 5/16 X 22G
44	1389	BUSHING 1/4 ID X .313
45	1447	BOLT 3/8 X 1-1/8 SHOULDER
46	9091	WASHER FLAT 3/8 SAE N
47	9945-2	BRAKE ROD FRONT - BLACK
48	12257-2	BRAKE ROD REAR - BLACK
49	1036	BRAKE BAND 4 INCH
50	9118	CLEVIS PIN 1/4 X 1.250 Z
51	9116	COTTER PIN 3/32 X .750 Z
52	6038	STEERING WHEEL
53	9799	STOP SWITCH WIRE ASSEMBLY
<b>NI</b>	12273	WIRE HARNESS
54	9080	BOLT 1/2-20 X 2.750
55	9160	BOLT 1/2-20 X .875
56	9796	BOLT #12-24 X .500 SELF TAPPING
57	6320	HEADREST PAD - SINGLE
58	11359	SEAT BACK/BOTTOM
59	1263	NUT 5/16-18 HEX FLANGED WHIZ
60	9978	CHAIN 35 X 66 ML (INCL. #110)
61	10750	COVER
62	1982-2	PEDAL LATCH - BLACK
63	1846	BOLT 1/2-20 X .750
64	9057	NUT 1/2-20 TOPLOCK
65	1854	WASHER #14 FLAT MS Z
66	4372	HANDHOLD STRAP
67	11330	DECAL SHEET - WARNINGS
68	11329	DECAL SHEET - BAR WARNINGS
69	2388	NUT 3/8-24 HEX
70	5732	WASHER 1/4 IEL
76	11361	FLAG MOUNTING BOLT
77	8778	LAP SHOULDER SEAT BELT
78	13504	BOLT 1/2-13 X 1.00 HHCS
79	9188	BOLT 1/2-13 X 1.50 HHCS

REF	PN	DESCRIPTION
80	9022	WASHER 1/2 STD FLAT
81	2386	BOLT 3/8-16 X 3.50
82	5287	BOLT #10-16 X .375 SELF TAPPING
83	5288	WIRE CLAMP
84	1189	NUT 5/16-18 HEX TOPLOCK
85	9189	BOLT 1/2-20 X .875 WHIZ FLANGE
86	1876	BOLT 1/2-20 X .625 WHIZ FLANGE
87	9968-2	SEAT FRAME - BLACK
<b>NI</b>	6983-2	SEAT SLIDE ADJUSTER PLATE - BLACK
89	5447	SAFETY FLAG - 6FT
90	12246	ENGINE
91	12971	CLUTCH
95	1398	WASHER 21/64 ID X 1-1/4 X 1/8
96	1124	WASHER 5/16 SPLITLOCK
97	1491	BOLT 5/16-24 X .750 HHCS
101	9101	BOLT 5/16-24 X .500 W/ NYLOK
102	9186	BOLT 5/16-18 X 1.50 LONG
103	9030	WASHER 5/16 IL
104	9060	WASHER 5/16 FLAT
105	8227	NUT 1/2-20 TINNERMAN
106	10749-2	ENGINE BACKING PLATE - BLACK
107	10537-2	OVERHEAD BAR - BLACK
108	10544-2	CENTER BAR - BLACK
109	10541-2	REAR BAR - BLACK
110	1269	MASTER LINK FOR 35 CHAIN

**ASM** = ASSEMBLY

**NI** = NOT ILLUSTRATED

\*\* = NOT SOLD SEPERATELY