

Operator's Manual
SUPPLEMENT
Model Nos.
415B-1, 415D-1
416B-27, 416D-1 416K-1

⚠ WARNING:

Read Engine
Owner's Manual,
Vehicle Operator's
Manual, and
Supplement
Carefully Before
Operating Vehicle.

Parts List



ORDERING PARTS

- FAST & EASY!**
- 1) Seek Part(s) from your models illustrated diagram, cross over REF# to PART#
 - 2) Type PART# into sites [Search Box] at GoKartsRus.com TIP! - RIGHT CLICK LINK, SELECT OPEN IN NEW TAB
 - 3) Add all needed parts to Shopping Cart | Complete "Checkout" | ✓ Done!
- LOWEST PRICES!**

If a part does not come up in a Site Search, please [Contact Us](#) (include part# in email)

**THIS VEHICLE IS FOR
OFF-ROAD USE ONLY**

BEFORE OPERATING THIS VEHICLE, THE OWNER AND/OR OPERATOR MUST UNDERSTAND THE VEHICLE WAS NOT DESIGNED OR MANUFACTURED TO MEET SPECIFICATIONS FOR USE ON STREETS, HIGHWAYS, OR THOROUGHFARES AND HAVE READ AND HAVE AN UNDERSTANDING OF ALL THE INSTRUCTIONS FOR SAFE ASSEMBLY AND OPERATION AS WELL AS THE INSTRUCTIONS GOVERNING THE ENGINE AND OTHER PORTIONS OF THE VEHICLE.

THROTTLE LINKAGE
DETAIL

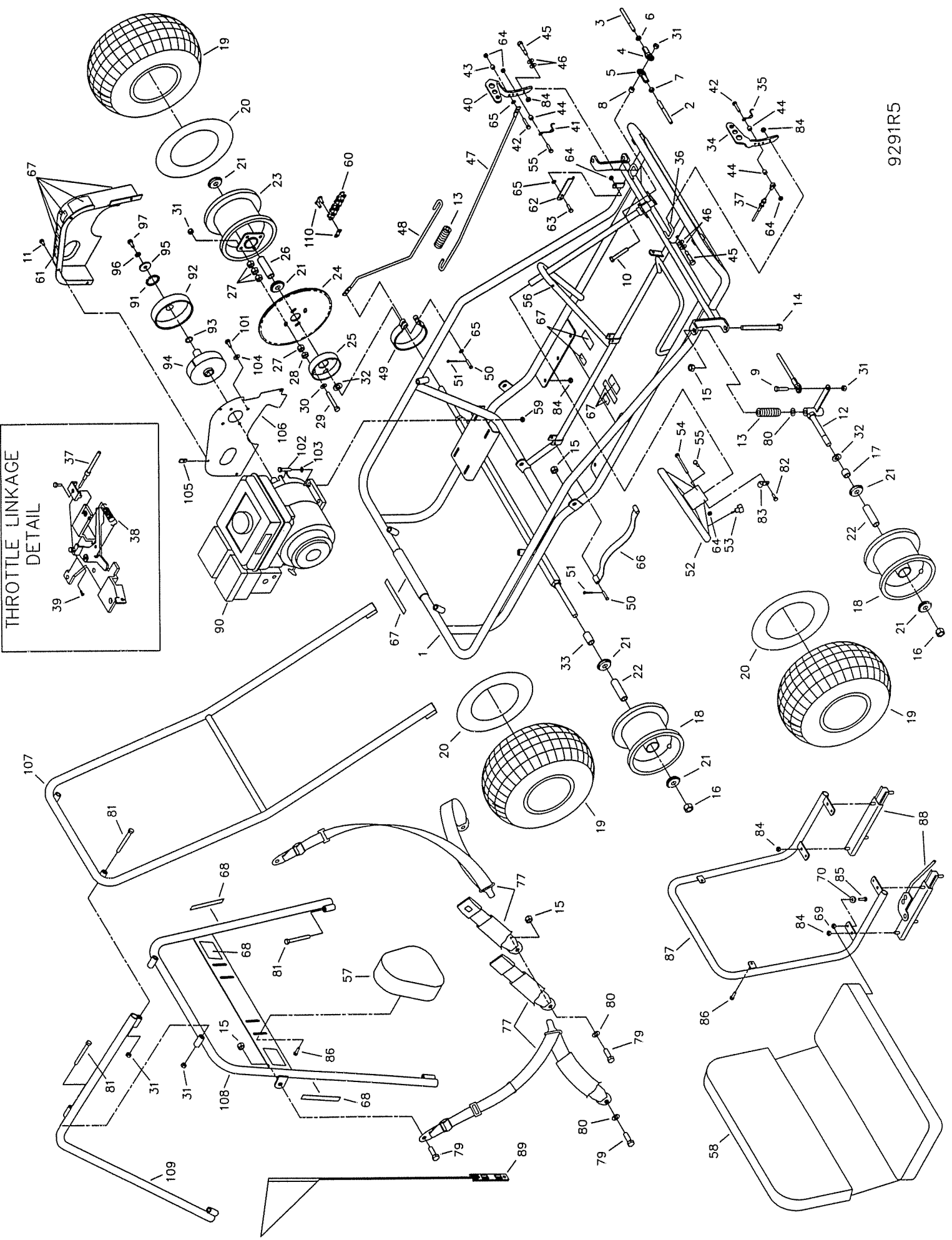

PARTS LIST FOR MODELS 415B, 415D, 416B-XX, 416D, 416K

REF NO.	PART NO.	DESCRIPTION	REF NO.	PART NO.	DESCRIPTION
1	12276-5	FRAME WELDMENT, RED	47	9945-2	BRAKE ROD - FRONT BLACK
ASM	10869	TIE ROD ASM LONG (INCL. 2, 4-7)	48	12257-2	BRAKE ROD - REAR BLACK
ASM	5020	TIE ROD ASM SHORT (INCL. 3-7)	49	1036	BRAKE BAND W/RETAINER
2	10868	TIE ROD 19.0	50	9118	PIN, CLEVIS 1/4 X 1.250 Z
3	5004	TIE ROD 7.25	51	9116	PIN, COTTER 3/32 X .750 Z
4	1415	TIE ROD END LH THREAD	52	6038	STEERING WHEEL
5	1414	TIE ROD END RH THREAD	53	9799	STOP SWITCH WIRE ASM
6	9024	NUT, 3/8-24 JAM LH THREAD	NI	12273	WIRE HARNESS
7	9092	NUT, 3/8-24 JAM RH THREAD	54	9080	BOLT, 1/4-20 X 2.750
8	9674-16	SPACER, 3/8 ID X 3/8 LONG	55	9160	BOLT, 1/4-20 X .875
9	9146	BOLT, 3/8-16 X 1.50	56	9796	BOLT, #12-24 X .500 SELF TAPPING
10	9158	BOLT, 3/8-16 X 2.25	57	6320	HEADREST PLAIN
11	9006	BOLT, 1/4-20 X .50 HEX FLANGED WHIZ	58	11359	SEAT - BACK/BOTTOM DBL PLAIN BLK
NI	10548-2Z	SPINDLE WELDMENT LEFT BLACK	59	1263	NUT 5/16-18 HEX FLANGED WHIZ
12	10549-2Z	SPINDLE WELDMENT RIGHT BLACK	60	9978	CHAIN, 35 X 86P (INCL. 110)
13	9709	COMPRESSION SPRING	61	10750	COVER, 415 W&W/0 SR
14	5682	BOLT, 1/2-13 X 5.500	62	1982-2	PEDAL LATCH, BLACK
15	1012	NUT, 1/2-13 TOPLOCK	63	1846	BOLT, 1/4-20 X .750
16	1046	NUT, 5/8-11 TOPLOCK	64	9057	NUT, 1/4-20 TOPLOCK
17	1104	SPACER SPLIT .8120D .625ID 1.000L	65	1854	WASHER, #14 FLAT MS Z
18	9309FP	WHEEL ASSEMBLY, IDLE (INCL. 19-22)	66	4372	HANDHOLD STRAP
ASM	10769	WHEEL ASSEMBLY, DRIVE (INCL. 20-21, 23-31)	67	10330	DECAL SHEET, MAIN FRAME AND ENGINE WARNINGS
19	4915	TIRE 145/70 X 6" KNOBBY	68	10329	DECAL SHEET, CENTER BAR WARNINGS
20	3802	INNER TUBE 6"	69	2388	NUT 3/8-24 HEX Z
21	5090	BEARING, 5/8" I.D.	70	5732	WASHER 1/4 IEL Z
22	5950	SPANNER, 5/8" I.D. X 2-1/8"	71	-----	-----
23	8499B	TIRE & DRIVE WHEEL ASSEMBLY 145/70 X 6"	72	-----	-----
24	9986	SPROCKET 35P X 80 TEETH	73	-----	-----
25	1246-16	BRAKE DRUM 4IN - ZINC PLTD	74	-----	-----
26	8598	SPANNER, 5/8 I.D. X 3.641	75	-----	-----
27	8409	NUT, 1/2-20 HEX	76	-----	-----
28	9169	NUT, 1/2-20 HEX JAM	77	8373	SEAT BELT - SHOULDER/LAP
29	9190	BOLT, 3/8-16 X 3-1/4	78	-----	-----
30	9091	WASHER, FLAT 3/8 SAE N	79	9188	BOLT, 1/2-13 X 1.50
31	9085	NUT, 3/8-16 TOPLOCK HEX	80	9022	WASHER, 1/2 FLAT
32	1119	SPACER, .625ID 1.0620D .125THK Z	81	2386	BOLT, 3/8-16 X 3.50
33	2024-16	SPACER, .8750D .625ID 1.500L Z	NI	8746M	VIDEO TAPE SAFETY MANCO
34	6309-16	PEDAL, THROTTLE TRIMMED	82	5287	BOLT #10-16 X .375 SELF TAPPING
35	9503	SPRING, PEDAL RIGHT WOUND	83	5288	WIRE CLAMP
36	9929	RUBBER CAP .25ID X .25 BLACK	84	1189	NUT, 5/16-18 HEX TOPLOCK
37	8251	THROTTLE CABLE 70.875 INCH RETURN SPRING	85	9189	BOLT, 1/4-20 X .875 HEX FLANGED WHIZ
38	12348	SWIVEL SCREW FOR ROBIN	86	1876	BOLT 1/4-20 X .625 HEX FLANGED WHIZ
39	12347	PEDAL, BRAKE TRIMMED	87	9968-2	SEAT FRAME WELDMENT BLACK
40	6293-16	SPRING, PEDAL LEFT WOUND	88	6734	SEAT SLIDE PR - SHORT (416X-XX)
41	9502	BOLT, 1/4-20 X 1.25	89	8445	FLAG SAFETY W/ BRKT 3FT
42	1848	BUSHING, 5/16 OD X 22G	90	12247	ENGINE 5HP OHC (415B, 415D)
43	6349	BUSHING, 1/4 ID X .313	91	12249	ENGINE 6.5HP OHC (416B, 416D)
44	1389	BOLT, 3/8 X 1-1/8 SHOULDER	92	12250	ENGINE 6.5HP OHC W/COIL (416K)
45	1447	WASHER, FLAT 3/8 SAE N			
46	9091				

ASM = ASSEMBLY
NI = NOT ILLUSTRATED

