

# Operator's Manual SUPPLEMENT

Model Nos.  
415B, 415D  
416B, 416D, 416K

## ⚠ WARNING:

Read Engine  
Owner's Manual,  
Vehicle Operator's  
Manual, and  
Supplement  
Carefully Before  
Operating Vehicle.

Parts List



## ORDERING PARTS

- FAST & EASY!**
- 1) Seek Part(s) from your models illustrated diagram, cross over REF# to PART#
  - 2) Type PART# into sites [Search Box] at [GoKartsRus.com](http://GoKartsRus.com) TIP! - RIGHT CLICK LINK, SELECT OPEN IN NEW TAB
  - 3) Add all needed parts to Shopping Cart | Complete "Checkout" | ✓ Done!
- LOWEST PRICES!**

If a part does not come up in a Site Search, please [Contact Us](#) (include part# in email)

# THIS VEHICLE IS FOR OFF-ROAD USE ONLY

BEFORE OPERATING THIS VEHICLE, THE OWNER AND/OR OPERATOR MUST UNDERSTAND THE VEHICLE WAS NOT DESIGNED OR MANUFACTURED TO MEET SPECIFICATIONS FOR USE ON STREETS, HIGHWAYS, OR THOROUGHFARES AND HAVE READ AND HAVE AN UNDERSTANDING OF ALL THE INSTRUCTIONS FOR SAFE ASSEMBLY AND OPERATION AS WELL AS THE INSTRUCTIONS GOVERNING THE ENGINE AND OTHER PORTIONS OF THE VEHICLE.

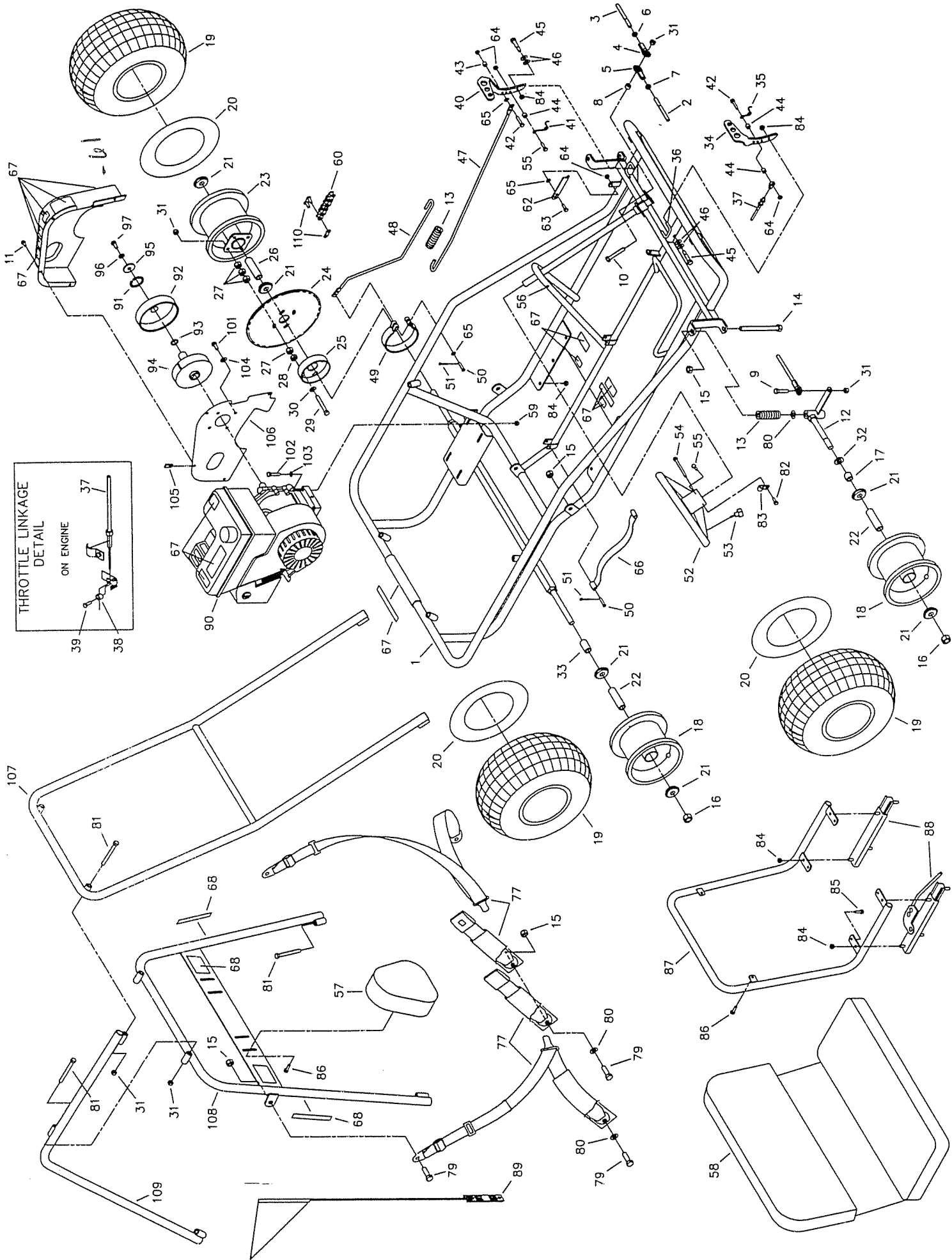

THROTTLE LINKAGE  
DETAIL  
ON ENGINE

39

38

37

**REPAIR PARTS - MODELS  
415B, 415D  
416B, 416D, 416K**

11 382-29  
416B-17

REF NO.	PART NO.	DESCRIPTION	REF NO.	PART NO.	DESCRIPTION
1	10525-5	FRAME WELDMENT, RED	44	1389	BUSHING, 1/4 ID X .313
ASM	10869	TIE ROD ASM LONG (INCL. 2, 4-7)	45	1447	BOLT, 3/8 X 1-1/8 SHOULDER
ASM	5020	TIE ROD ASM SHORT (INCL. 3-7)	46	9091	WASHER, FLAT 3/8 SAE N
2	10868	TIE ROD 19.0	47	9945-2	BRAKE ROD - FRONT BLACK
3	5004	TIE ROD 7.25	48	9946-2	BRAKE ROD - REAR BLACK
4	1415	TIE ROD END LH THREAD	49	1036	BRAKE BAND W/RETAINER
5	1414	TIE ROD END RH THREAD	50	9118	PIN, CLEVIS 1/4 X 1.250 Z
6	9024	NUT, 3/8-24 JAM LH THREAD	51	9116	PIN, COTTER 3/32 X .750 Z
7	9092	NUT, 3/8-24 JAM RH THREAD	52	6038	STEERING WHEEL
8	9674-16	SPACER, 3/8 ID X 3/8 LONG	53	9799	STOP SWITCH WIRE ASM
9	9146	BOLT, 3/8-16 X 1.50	NI	1406	STOP SWITCH WIRE EXTENSION
10	9158	BOLT, 3/8-16 X 2.25	54	9080	BOLT, 1/4-20 X 2.750
11	9006	BOLT, 1/4-20 X .50 HEX FLANGED WHIZ	55	9160	BOLT, 1/4-20 X .875
NI	10548-2Z	SPINDLE WELDMENT LEFT BLACK	56	9796	BOLT, #12-24 X .500 SELF TAPPING
12	10549-2Z	SPINDLE WELDMENT RIGHT BLACK	57	6320	HEADREST PLAIN
13	9709	COMPRESSION SPRING	58	8370	SEAT BACK/BOTTOM
14	5682	BOLT, 1/2-13 X 5.500	59	1263	NUT 5/16-18 HEX FLANGED WHIZ
15	1012	NUT, 1/2-13 TOPLOCK	60	9978	CHAIN, 35 X 86P (INCL. 110)
16	1046	NUT, 5/8-11 TOPLOCK	61	10750	COVER, 415 W&W/O SR
17	1104	SPACER SPLIT .8120D .625ID 1.000L	62	1982-2	PEDAL LATCH, BLACK
18	9309FP	WHEEL ASSEMBLY, IDLE (INCL. 19-22)	63	1846	BOLT, 1/4-20 X .750
ASM	10769	WHEEL ASSEMBLY, DRIVE (INCL. 20-21, 23-31)	64	9057	NUT, 1/4-20 TOPLOCK
19	4915	TIRE 145/70 X 6" KNOBBY	65	1854	WASHER, #14 FLAT MS Z
20	3802	INNER TUBE 6"	66	4372	HANDHOLD STRAP
21	5090	BEARING, 5/8" I.D.	67	10330	DECAL SHEET, MAIN FRAME AND ENGINE WARNINGS
22	5950	SPANNER, 5/8" I.D. X 2-1/8"	68	10329	DECAL SHEET, CENTER BAR WARNINGS
23	8499B	TIRE & DRIVE WHEEL ASSEMBLY 145/70 X 6"	69	-----	-----
24	9986	SPROCKET 35P X 80 TEETH	70	-----	-----
25	1246	BRAKE DRUM, 4"	71	-----	-----
26	8598	SPANNER, 5/8 I.D. X 3.641	72	-----	-----
27	8409	NUT, 1/2-20 HEX	73	-----	-----
28	9169	NUT, 1/2-20 HEX JAM	74	-----	-----
29	9190	BOLT, 3/8-16 X 3-1/4	75	-----	-----
30	9091	WASHER, FLAT 3/8 SAE N	76	-----	-----
31	9085	NUT, 3/8-16 TOPLOCK HEX	77	8373	SEAT BELT - SHOULDER/LAP
32	1119	SPACER .625ID 1.0620D .125THK Z	78	-----	-----
33	2024-16	SPACER .875OD .625ID 1.500L Z	79	9188	BOLT, 1/2-13 X 1.50
34	6309-16	PEDAL, THROTTLE TRIMMED	80	9022	WASHER, 1/2 FLAT
35	9503	SPRING, PEDAL RIGHT WOUND	81	2386	BOLT, 3/8-16 X 3.50
36	9929	RUBBER CAP .25ID X .25 BLACK	NI	8746M	VIDEO TAPE SAFETY MANCO
37	8252	THROTTLE CABLE 61 INCH	82	5287	BOLT #10-16 X .375 SELF TAPPING
38	2748	CABLE STOP NUT	83	5288	WIRE CLAMP
39	2666	SWIVEL SCREW	84	1189	NUT, 5/16-18 HEX TOPLOCK
40	6293-16	PEDAL, BRAKE TRIMMED	85	9189	BOLT, 1/4-20 X .875 HEX FLANGED WHIZ
41	9502	SPRING, PEDAL LEFT WOUND	86	1876	BOLT 1/4-20 X .625 HEX FLANGED WHIZ
42	1848	BOLT, 1/4-20 X 1.25	87	9968-2	SEAT FRAME WELDMENT BLACK
43	6349	BUSHING, 5/16 OD X 22G	88	6734	SEAT SLIDE PR - SHORT
			89	8445	FLAG SAFETY W/ BRKT 3FT

ASM = ASSEMBLY  
NI = NOT ILLUSTRATED